

Dimensions & Data Certified for:

Representative:

Customer:

Project:

Requirements:

Order:

Order:

By:

Date:

M1447

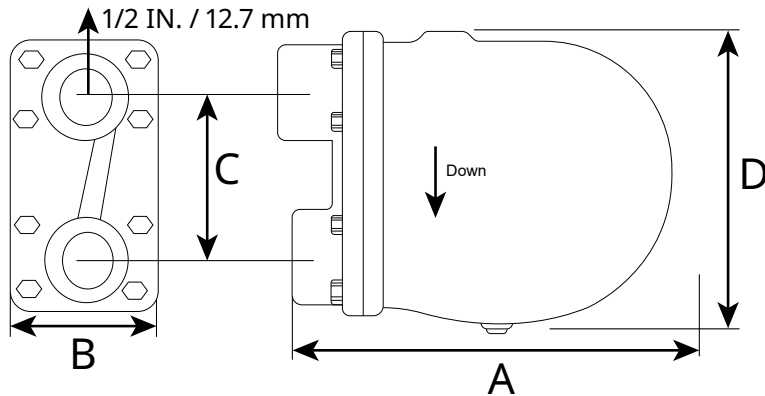

FTH SERIES

PMA Max. Allowable Pressure 200 psig / 13.8 barg

TMA Max. Allowable Temperature 450°F / 232°C

Dimensions and Weights

| Type | A ⁽¹⁾ | | B | | C | | D | | Weights | |
|-------------------------|------------------|-----|-------|-----|-------|-----|--------|-----|---------|----|
| | in. | mm | in. | mm | in. | mm | in. | mm | lb | kg |
| FTH-C2H9A and FTH-C2H9M | 12-1/4 | 311 | 6 | 152 | 4-1/2 | 114 | 10-3/4 | 273 | 44 | 20 |
| FTH-C5H9A and FTH-C5H9M | 16-1/2 | 419 | 7-1/2 | 190 | 4-1/2 | 114 | 10-3/4 | 273 | 62 | 28 |
| FTH-C5J9A and FTH-C5J9M | 20-1/2 | 521 | 8-2/3 | 221 | 7-1/2 | 190 | 12-4/5 | 325 | 117 | 53 |

1. Dimension without pit cock, deduct 4 in. / 102 mm
Note: Offset 1/2 in / 12.7 mm for all dimensions

| Description | Material |
|----------------------|---|
| Head and Body | Cast iron |
| Bolts | Steel |
| Gaskets | Compressed Graphite |
| Lever Assembly | Stainless steel |
| Float, Plug and Seat | Stainless steel |
| Air Vent | Stainless steel/Phosphorus Bronze or Monel® |

Monel® is a marked owned by Special Metals Corporation.



Spence Contact Information:

www.SpenceValve.com
Mckinney, Texas 75069 USA
T +1 972 548 3574

DISCLAIMER: Please note that there may be variations in the product depicted based on your specific model number. Please review your Product Literature for further guidance.

CONFIDENTIAL: This document/program, including the content, is property of Emerson Process Management and must be held in strict confidence and properly safeguarded by the recipient at all times. It may not be copied or reproduced, or provided or revealed to any other part, except with prior authorization of an appropriate officer of Emerson Process Management and any authorised copy or reproduction must include this admonition. The recipient may use the same only for the purpose for which Emerson Process Management has provided it to the recipient. The document must be returned to the recipient agrees to the foregoing.

Product

High Capacity Steam Trap FTH Series

Date: 10/2024

Rev: 1